

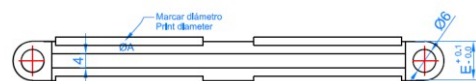

COLLIER DOUBLE ISOPHONIQUE M6 BICHROMATÉ

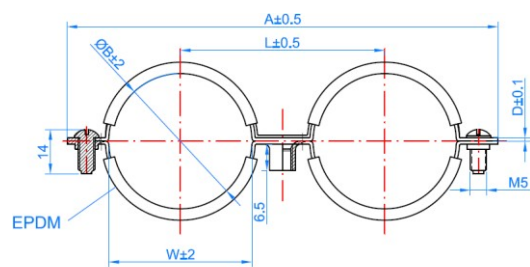

PARAMETRES D'INSTALLATION

CODE	Ø B [mm]	Ø B (")	Largeur	Epaisseur
ABDI012	12	1/8"	11,7 ÷ 1,0	100
ABDI015	15	1/4"	11,7 ÷ 1,2	100
ABDI018	18	3/8"	11,7 ÷ 1,2	100
ABDI022	22	1/2"	11,7 ÷ 1,2	100
ABDI028	28	3/4"	11,7 ÷ 1,2	100

MATÉRIAUX :



tube PVC



tube acier

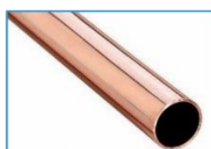

tube cuivre